

SVA028-S



Features

- 1/3" SONY EXview Super HD 960H CCD
- 700TV Lines Horizontal Resolution
- Excellent Low Light Sensitivity of 0.3Lux/F1.2
- Day & Night
- IR Smart
- De-moire
- DWDR : Digital Wide Dynamic Range
- DNR : Digital Noise Reduction
- BLC : Back Light Compensation
- HLC : High Light Compensation
- Dead Pixel Correction
- Lens Shading
- Privacy Mask
- Board Lens f=2.9(120')mm (Option 2.45mm(150') Lens)
- * Extension Cable : Stereo Jack(5M)



1/3 SONY
SUPERHAD CCD



DAY & NIGHT



DIGITAL
WDR
DIGITAL WIDE
DYNAMIC RANGE



DNR
DIGITAL NOISE
REDUCTION



BLC
BACKLIGHT
COMPENSATION



HLC
HIGH-LIGHT
COMPENSATION



DPC
DEAD PIXEL
COMPENSATION



LSC
LENS SHADING
COMPENSATION



3.6mm
BOARD LENS



DC 5V

Dimensions

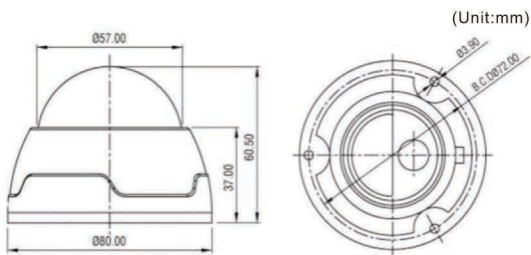

Cable



Alternative Views



Specifications

SVA028-S		
Signal Format	NTSC	PAL
Horizontal Resolution	Horizontal : 700 TV-Line (Color)	
Image Sensor	SONY 1/3" EXview HAD CCD, Super HAD CCD II	
Total Pixels	1020(H) x 508(V)	1020(H) x 596(V)
Effective Pixels	976(H) x 494(V)	976(H) x 582(V)
Scanning System	2:1 Interlace	
Synchronization	Internal	
Scanning Frequency	15.734 KHz(H), 59.94 Hz(V)	15.625 KHz(H), 50.00 Hz(V)
Video Output	CVBS : 1.0Vp-p/75Ω	
Min. Illumination	Color : 0.03Lux(50IRE@F1.2)	
Electronic Shutter	1/60 ~ 1/100,000 sec	1/50 ~ 1/100,000 sec
Iris Control	DC / VIDEO / MANUAL	
Signal to Noise Ratio	52dB (AGC Off, Weight On)	
Backlight Compensation	DWDR / BLC / HSBLIC / Off	
White Balance	ATW / AWB / AWC-SET / MANUAL	
D - EFFECT	Mirror / NEG.IMAGE	
Gain Control	Low / Middle / High / Off	
DNR	ON / OFF (Level Adjustable)	
Day & Night	Color/ Auto / EXT / Night(B/W)	
IR Smart	ON	
Digital WDR	ON	
Language	English / Chinese / Espanol / Russian / Deutsch / Portuguese / French / Japanese	
Input Voltage	DC 12V	
Power Consumption	Max. 2.0W[400mA](IR LED ON)	
Operating Temperature	-10°C ~ +50°C (+14°F ~ +122°F)	
Operating Humidity	30% ~ 80% RH	
Dimension	80.0 (Ø) x 60.5 mm (L)	